

A photograph of a modern, two-story elementary school building. The building features a light-colored stone or brick facade with large, rectangular windows. The ground floor has a series of wooden-slatted doors or panels. In the foreground, there is a green artificial turf field with a white diamond-shaped logo. An American flag flies on a tall pole in the center of the building. The sky is clear and blue.

Clearview Elementary
hanover, pa

Clearview Elementary

LEED GOLD certified building 42 | 69

- Kindergarten – Forth Grade Elementary School 43,600 sq ft.
- Built on the Site of an Existing Elementary School
- From the Beginning they used an Integrated Design Process
- Goal was SILVER Certified Building- with the Integration of the Physical Environment with the Learning Environment.

Clearview Elementary

indoor environment quality 11 | 15

- Geothermal Heat Pumps
- Permanent Air Sensors for Monitoring
- Floor Mounted Air Diffusers
- Natural Sunlight

Clearview Elementary

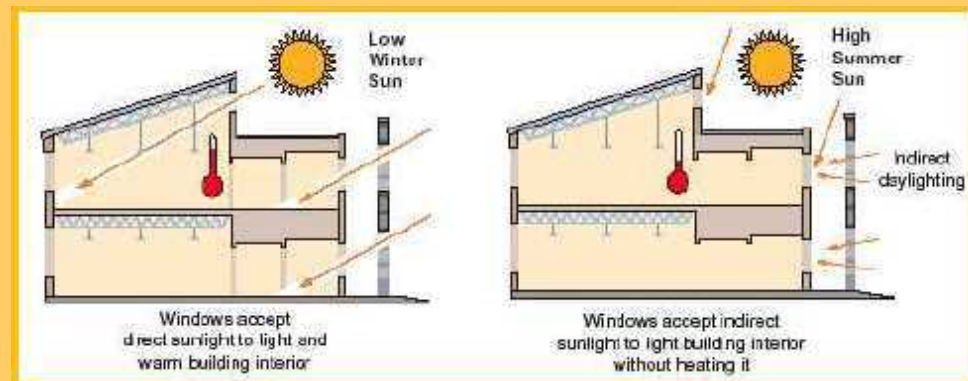
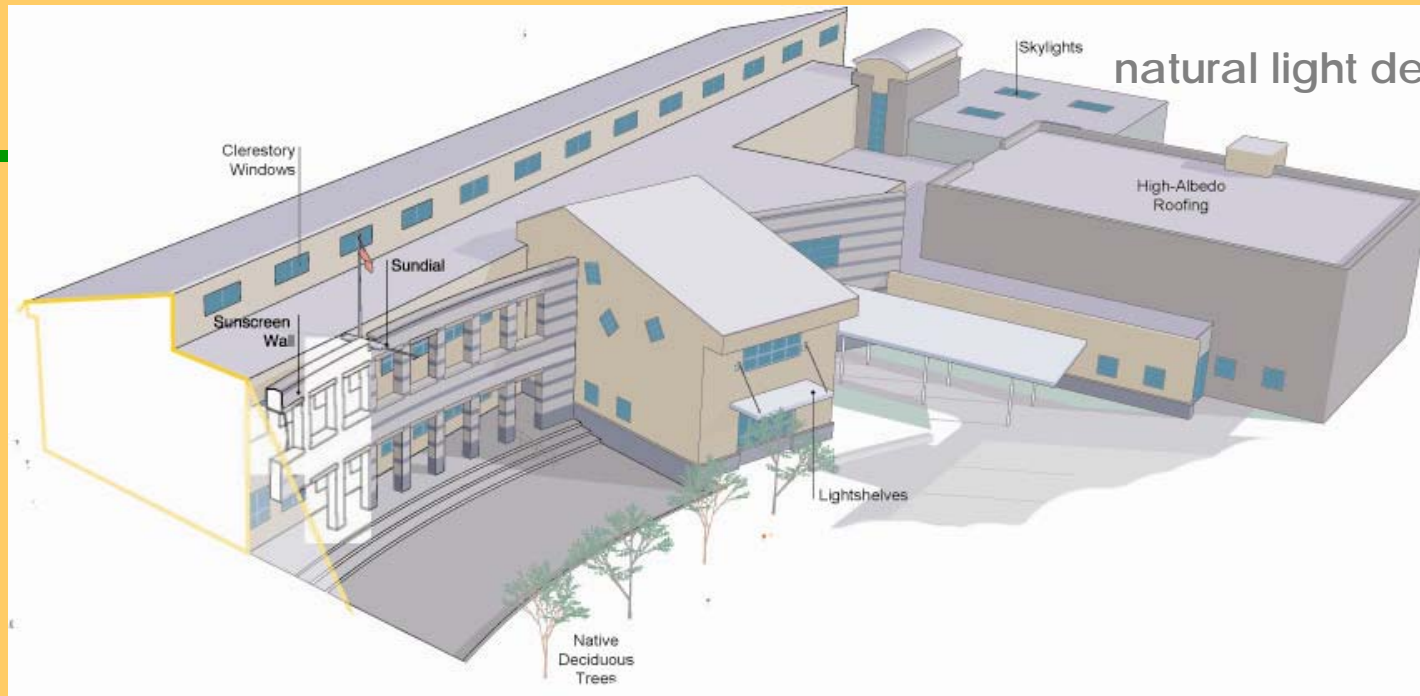

Clearview Elementary

materials and resources 7 | 13

- High Recycled Content
- 75% of Construction Waste Diverted from Landfill-75%
- Locally Harvested Materials- 40%
- Materials and Resources to Enhance Building Envelope
- Life Cycle Analysis

Clearview Elementary

energy and atmosphere 10 | 17

- 40% Less Energy Use than a Conventional School
- East West Orientation of the Building.
- Enhanced Building Envelope through Insulating Materials

Clearview Elementary

water efficiency 4 | 5

- Waterless Fixtures Such as Urinals
- Automatic Faucets
- Use of Indigenous Plants

Clearview Elementary

innovation and design process 5 | 5

- Integrated Design Process from the Beginning
- Use of Computer Modeling to Understand the Effect of the Design Decision.

Clearview Elementary

conclusion

- 40% Energy Reduction
- 30% Reduced Water Use
- \$18,000 Yearly Energy Savings
- Opportunity to Positively Influence the Thought Process of Children

Clearview Elementary

sources

- www.USGBC.org
- U.S. Team Building Challenge 2002
- www.designshare.com
- www.aia.orf
- 2003 Northeast Green building Awards entry Form
- www.cement.org